

FIRM MAP # 45071C - 0460 C DATED: 08-16-11
 THE UNDERSIGNED STATES THAT TO THE BEST OF HIS KNOWLEDGE AND BELIEF THE LOCATION OF THE SUBJECT
 OR PROPERTY (IS NOT) LOCATED IN A SPECIAL FLOOD HAZARD AREA.
 I HEREBY STATE THAT TO THE BEST OF MY PROFESSIONAL KNOWLEDGE, INFORMATION, AND BELIEF, THE SURVEY SHOWN
 IN SOUTH CAROLINA AND MEETS OR EXCEEDS THE REQUIREMENTS FOR A CLASS B SURVEY AS SPECIFIED THEREIN.
 ALSO THERE ARE NO VISIBLE ENCROACHMENTS OR PROJECTIONS OTHER THAN SHOWN.

BELTER & ASSOCIATES, INC. 5245 WESCOTT ROAD COLUMBIA, SOUTH CAROLINA 29212 TELEPHONE: (803) 735-4004

DATE: _____ G. BRADLEY, JR. SCLS # 19388

EXCEPT AS SPECIFICALLY STATED OR SHOWN ON THIS PLAN, THIS SURVEY DOES NOT PURPORT TO REFLECT ANY OF THE FOLLOWING WHICH MAY BE POSSIBLE ENCUMBRANCES THAT WERE VISIBLE AT THE TIME OF MAKING OF THIS SURVEY: BUILDINGS; BARRIERS; FENCES; OR OTHER ENCUMBRANCES; AND ANY OTHER FACTS THAT AN ACCURATE AND CURRENT TITLE SEARCH ONLY THE LISTED DOCUMENTS SHOWN HEREON WERE CONSIDERED AS A PART OF THIS SURVEY. VISIBLE STRUCTURES, LOCATIONS OF UNDERGROUND UTILITY LINES, AND VISIBLE ENCROACHMENTS OR PROJECTIONS ARE SHOWN HEREON UNLESS DESIGNATED WITH BEARINGS & DISTANCES.

SHOWN AS: LOT 218 BLOCK _____
 ON A PLAN OF: STEWART LANDING SUBDIVISION
 BY: BELTER & ASSOCIATES, INC.
 DATED: 08-08-21 REVISED: 08-13-21 AND RECORDED IN THE
 OFFICE OF R/D FOR: NEWBERRY COUNTY IN RECORD
 BOOK 0212 PAGE 10, BOOK 0213 PAGES 1-10 & BOOK 0214 PAGES 1 & 2
 ADDITIONAL REF.: _____

SCALE: 1" = 40'
 DRAWING DATE: 08-14-21
 LOT AREA: 179,286 S.F.
 4.12 ACRES
 NEWBERRY COUNTY TMS# 594-22-218
 JOB NO. 210143

VACANT LOT SURVEY PREPARED FOR:
MARCUS RABUN
 BELTER & ASSOCIATES, INC.
 No. 000787
 STATE OF SOUTH CAROLINA
 REGISTERED PROFESSIONAL SURVEYOR

NEAR PROSPERITY, S.C. IN NEWBERRY COUNTY
 EEE-117

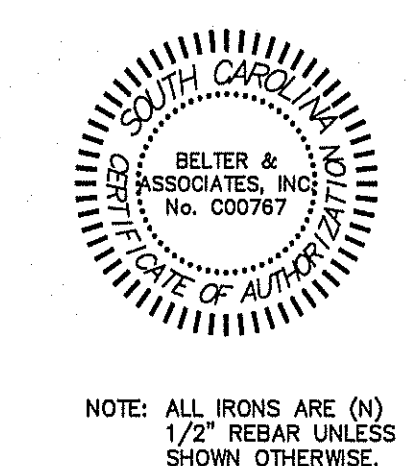

NOTE: ALL IRONS ARE (N) 1/2" REBAR UNLESS SHOWN OTHERWISE.